



- Two double bedrooms
- Two bathrooms (One En-Suite)
- Open plan kitchen / diner
- Modern and contemporary

7, The Crescent, Gloucester Road, Cheltenham,

An open-plan modern apartment in the sought after residence of The Crescent

Guide Price £250,000



Property Description

Full Description

VIDEO AVAILABLE

Situated on the first floor of this sought after private residence this spacious and modern first floor apartment consists of a good sized entrance hall with double doors leading to a spacious open-plan reception / kitchen diner with fully integrated appliances and patio doors leading to a private balcony overlooking the landscaped gardens. To the front elevation are two double bedrooms, the master has a fitted walk-in double wardrobe and en-suite shower room. To the rear of the property is a family bathroom comprising of a modern bathroom suite including glass washbasin, low level W.C, and bath with over-bath shower. The property also benefits from zone controlled under floor heating, spectacular views overlooking the communal landscaped gardens, allocated off road parking, visitors parking and good storage. Situated off The Gloucester Road, The Crescent is a gated community accessed via a private road. The apartment spanning approx.764 sq. foot serves as the perfect Cheltenham residence.

Council Tax: Band C

Annual service charge: £2,270

Ground rent: £125.00



The Crescent, Gloucester Road, Cheltenham, GL51

APPROX. GROSS INTERNAL FLOOR AREA 764 SQ FT 70.9 SQ METRES

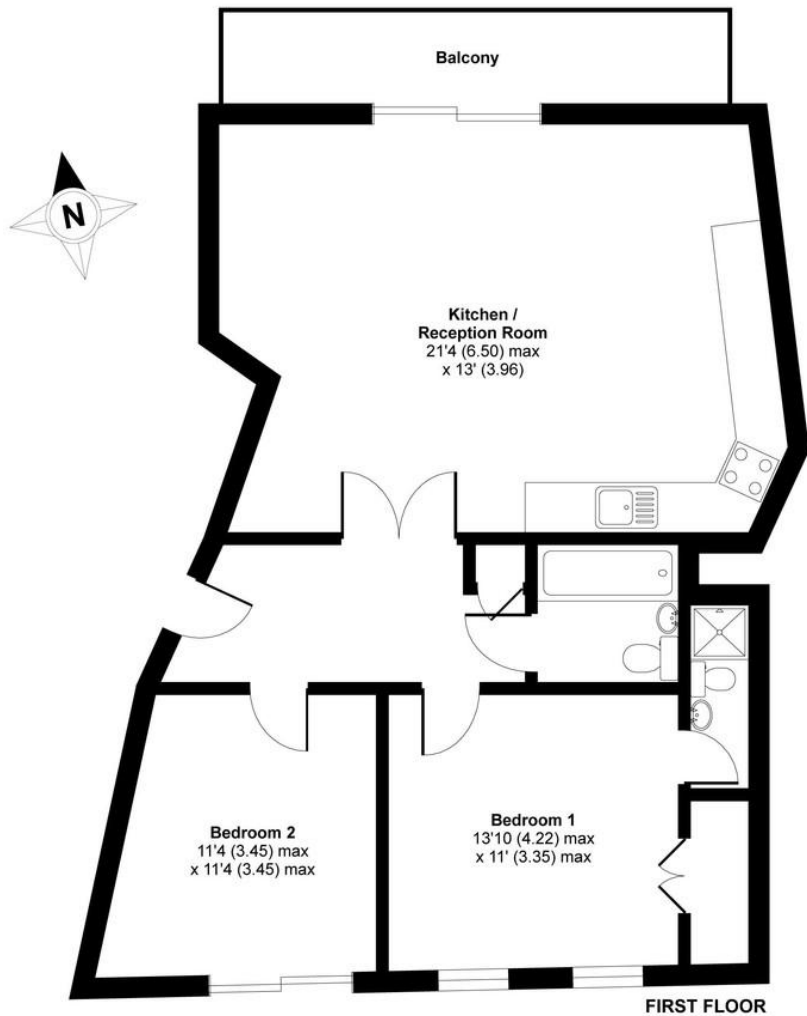

COMPLETE PROPERTY GROUP LTD
4 Bath Mews, Bath Parade
Cheltenham
Gloucestershire
GL53 7HL

CONTACT DETAILS
01242 256700
info@completepg.co.uk
www.completepropertygroup.co.uk

Agents Note: Whilst every care has been taken to prepare these sales particulars, they are for guidance purposes only. All measurements are approximate and for general guidance purposes only and whilst every care has been taken to ensure their accuracy, they should not be relied upon and potential buyers are advised to recheck the measurements.